

## TECHNICAL CHARACTERISTICS

### ANCHOR SYSTEM

#### AGL

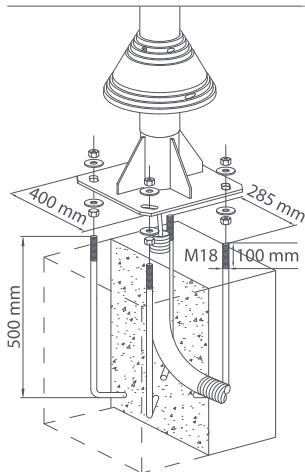

### SECTIONS

#### SINERGY TUBE Ø 75

Interior  
Tube Ø 70 x 4  
Galvanized Steel

Exterior  
Tube Ø 75 x 2,5  
Engineered Technical  
Polymers

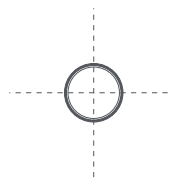

#### SYNERGY TUBE Ø 205

Interior  
Tube Ø 200 x 4  
Galvanized Steel

Exterior  
Tube Ø 205 x 2,5  
Engineered Technical  
Polymers

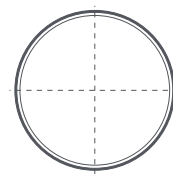

### SPECIFICATIONS

#### INSULATION LEVEL

CLASS II (UNE EN 60598)

#### AENOR CERTIFICATE

Nº 019/000131

#### CE CERTIFICATE OF CONFORMITY

0099/CDP/A55/A0099

#### AGM

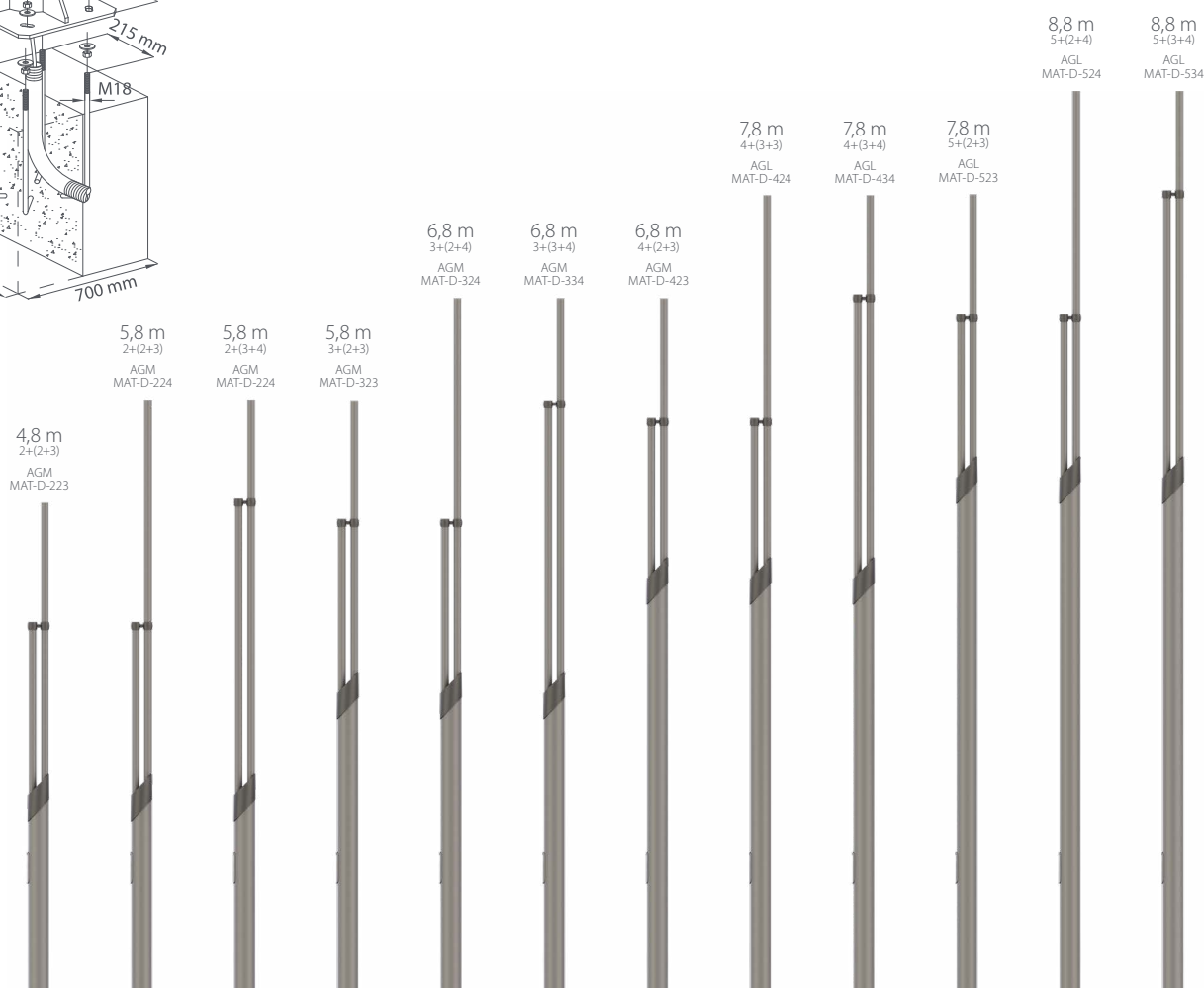
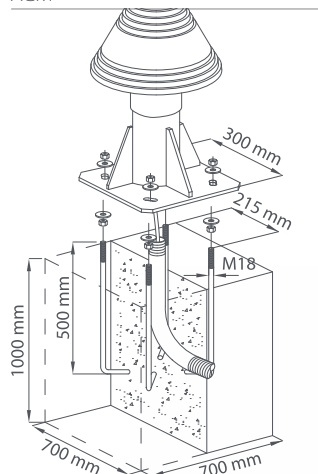

## TECHNICAL CHARACTERISTICS

### ANCHOR SYSTEM

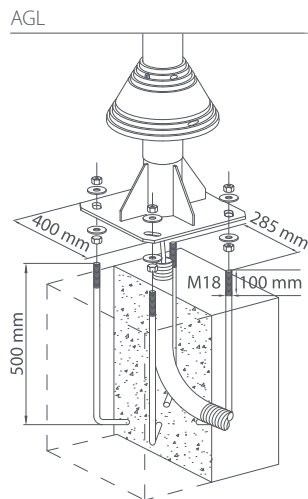

### SECTIONS

#### SINERGY TUBE Ø 75

Interior  
Tube Ø 70 x 4  
Galvanized Steel

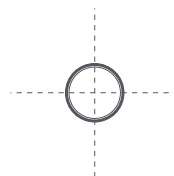

Exterior  
Tube Ø 75 x 2,5  
Engineered Technical  
Polymers

#### SYNERGY TUBE Ø 205

Interior  
Tube Ø 200 x 4  
Galvanized Steel

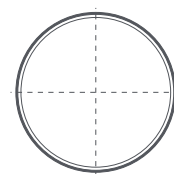

Exterior  
Tube Ø 205 x 2,5  
Engineered Technical  
Polymers

### SPECIFICATIONS

#### INSULATION LEVEL

CLASS II (UNE EN 60598)

#### AENOR CERTIFICATE

Nº 019/000131

#### CE CERTIFICATE OF CONFORMITY

0099/CDP/A55/A0099

